

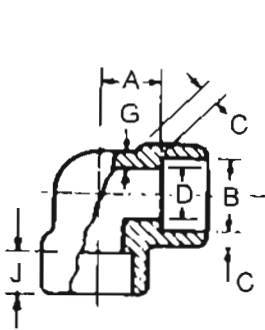

SOCKET-WELDING FITTINGS

ASME B16.11-1996 (REVISION OF ASME B16.11-1991)



90° ELBOW

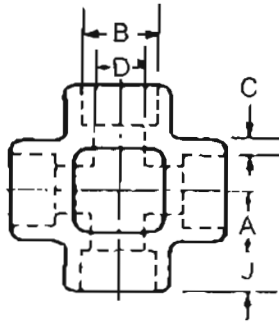

CROSS

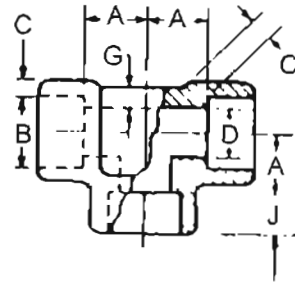

TEE

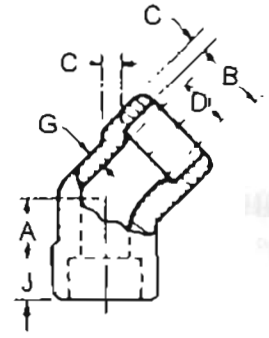

45° ELBOW

DN	Nom. Pipe Size	Socket Bore Dia. (2) B	Bore Diameter of Fittings(2) D			Socket Wall Thickness(1) C						Body Wall Thickness G			Depth of Socket Min. J
						Class Designation						Class Designation			
			Class Designation			3000		6000		9000		3000	6000	9000	
			3000	6000	9000	Ave.	Min.	Ave.	Min.	Ave.	Min.	Min.	Min.	Min.	
6	1/8	11.2	7.6	4.8		3.18	3.18	3.96	3.43			2.41	3.15		9.5
		10.8	6.1	3.2											
8	1/4	14.6	10.0	7.1		3.78	3.30	4.60	4.01			3.02	3.68		9.5
		14.2	8.5	5.6											
10	3/8	18.0	13.3	9.9		4.01	3.50	5.03	4.37			3.20	4.01		9.5
		17.6	11.8	8.4											
15	1/2	22.2	16.6	12.5	7.2	4.67	4.09	5.97	5.18	9.35	8.18	3.73	4.78	7.47	9.5
		21.8	15.0	11.0	5.6										
20	3/4	27.6	21.7	16.3	11.8	4.90	4.27	6.96	6.04	9.78	8.56	3.91	5.56	7.82	12.5
		27.2	20.2	14.8	10.3										
25	1	34.3	27.4	21.5	16.0	5.69	4.98	7.92	6.93	11.38	9.96	4.55	6.35	9.09	12.5
		33.9	25.9	19.9	14.4										
32	1-1/4	43.1	35.8	30.2	23.5	6.07	5.28	7.92	6.93	12.14	10.62	4.85	6.35	9.70	12.5
		42.7	34.3	28.7	22.0										
40	1-1/2	49.2	41.6	34.7	28.7	6.35	5.54	8.92	7.80	12.70	11.12	5.08	7.14	10.15	12.5
		48.8	40.1	33.2	27.2										
50	2	61.7	53.3	43.6	38.9	6.93	6.04	10.92	9.50	13.84	12.12	5.54	8.74	11.07	16.0
		61.2	51.7	42.1	37.4										
65	2-1/2	74.4	64.2			8.76	7.67					7.01			16.0
		73.9	61.2												
80	3	90.3	79.4			9.52	8.30					7.62			16.0
		89.8	76.4												
100	4	115.7	103.8			10.69	9.35					8.56			19.0
		115.2	100.7												

NOTES:

(1) Average of Socket Wall Thickness around periphery shall be no less than listed values.

The minimum values are permitted in localized areas.

(2) Upper and lower values for each size are the respective maximum and minimum dimensions.

(3) DIMENSIONAL TOLERANCES: see page 17