

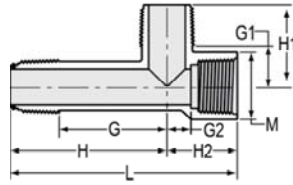

Schedule 40 Fittings Technical
Schedule 40 Fittings Dimensions & Information

Manifold Tee - O-ring Sealed

O-ring Sealed Mipt x Fipt x Mipt
 EPDM O-ring Seal on Tee run



Part Number	Size	G	G1	G2	H	H1	H2	L	M	Approx. Wt. (Lbs.)
451A-010	1	2-19/32	1	9/16	3-25/32	2	1-11/16	5-15/32	1-21/32	.19

90° EII

Socket x Socket

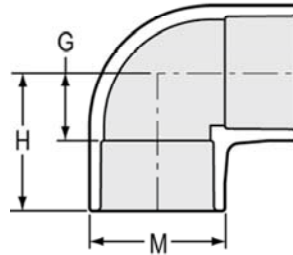

Part Number	Size	G	H	M	Approx. Wt. (Lbs.)
406-003	3/8	3/8	1- 1/8	7/8	.02
406-005	1/2	1/2	1- 1/4	1-3/32	.04
406-007	3/4	9/16	1- 1/2	1-5/16	.07
406-010	1	11/16	1-25/32	1- 5/8	.11
406-012	1-1/4	31/32	2- 5/32	2	.20
406-015	1-1/2	1- 1/16	2-3/8	2- 1/4	.25
406-020	2	1-5/16	2-11/16	2- 3/4	.37
406-025	2-1/2	1-17/32	3-5/16	3-11/32	.73
406-030	3	1-7/8	3-3/4	4	1.05
406-040	4	2-13/32	4-7/16	5- 1/32	1.71
406-045F*	4-1/2	8- 5/8	6- 1/8	5- 7/16	3.54
406-050	5	3- 1/16	6-1/16	6- 5/32	3.24
406-060	6	3-9/16	6- 9/16	7- 9/32	4.66
406-080	8	4-13/32	8- 7/16	9- 3/8	8.89
406-100	10	5-27/32	10-27/32	11-19/32	15.55
406-100F*	10	9-13/16	15-1/16	11- 1/2	17.51
406-120	12	6-15/16	12-15/16	13-11/16	27.98
406-120F*	12	11-3/16	17-7/16	13- 9/16	30.66
406-140	14	7- 1/2	14- 1/2	15-9/16	54.20
406-140F*	14	13-3/16	20-3/16	14- 7/8	41.54
406-160F*	16	15-1/4	23-1/4	17	59.37
406-180F*	18	17-5/16	26-5/16	19- 1/8	82.00
406-200F*	20	19-13/16	29-13/16	21-3/16	118.12
406-240F*	24	23-7/16	35-7/16	25- 3/8	172.90

* Fabricated